



19A Ashvale Street Flinders View QLD

3  2  2 

Accommodation consists of three well sized bedrooms, all of which are appointed with built-in wardrobes and the master features a fully tiled en-suite. Delivering a lifestyle of unparalleled convenience, you will be within an effortless level stroll of the heart of Ipswich.

It reveals a warm and welcoming lounge/dining and a separate kitchen. the home offers formal & informal entertaining areas all opening to a low maintenance large backyard.

Complete with an invaluable double car lock-up garage, this exceptional home boasts ultra-convenience within a stroll of Winston Glade shopping centre well as cosmopolitan village eateries, shops, boutiques, and Ripley Valley State School and public transport at the doorstep.

Price : Best offer before 03.08.2024 at 3pm
Land Size : 131 sqm
View : <https://www.teamestateagents.com.au/sale/qld/ipswich-west-moreton/flinders-view/residential/house/8082221>



Madu
0433191948

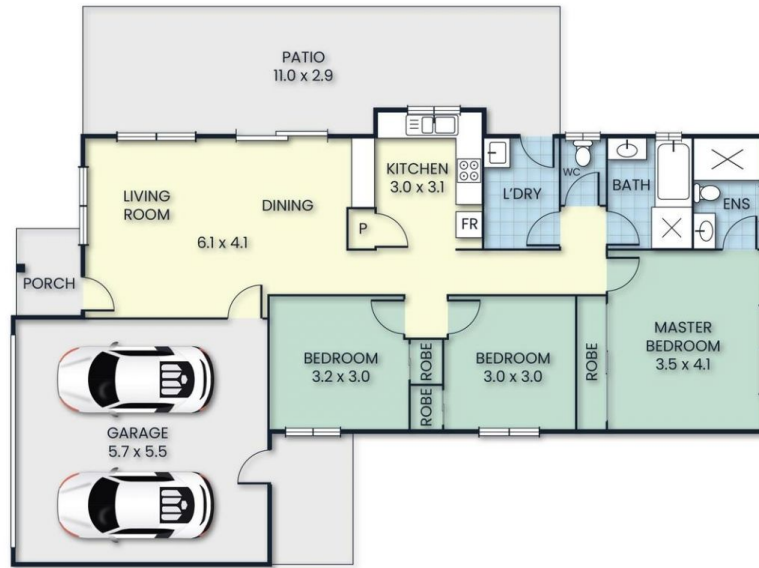

19A Ashvale St, FLINDERS VIEW

Internal 129 m² External 40 m² Total 169 m²

3 x 2 x 2 x

Conditions of use: All floor plan measurements, positions and angles are approximate and for illustrative purpose only. New View Photography makes no guarantee of the accuracy of any measurements, symbols or texture as the intent of this floor plan is to indicate the approximate layout of the property only. While every attempt at accuracy is made, potential buyers must seek their own independent professional measurements to determine the home's suitability before purchase. New View Photography accepts no responsibility or liability for any loss from using this floor plan. The floor plan must not be reused or resold for any reason without prior written consent from New View Photography.

NEWVIEW
PHOTOGRAPHY